

Vesticam2 IR video goggles

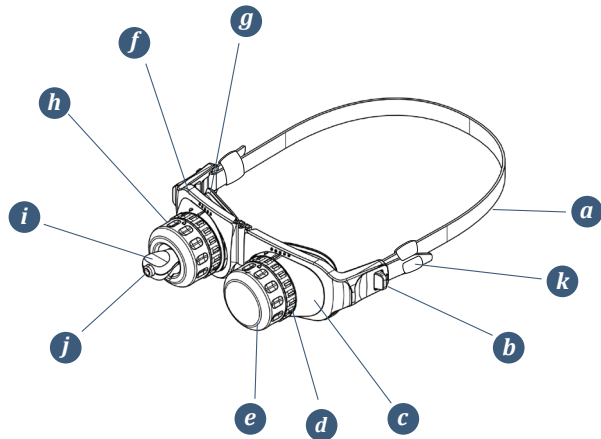

- a** silicone head band
- b** quick release side buttons
- c** mounting plate - adjusts for interpupillary variation
- d** locking ring
- e** eye patch cylinder
- f** flexible goggles frame
- g** silicone eye cups - removeable and reusable
- h** camera cylinder - with infra-red USB camera and fixation light
- i** joystick - for focus and fine adjustment
- j** fixation light button
- k** cable clip to secure head band end

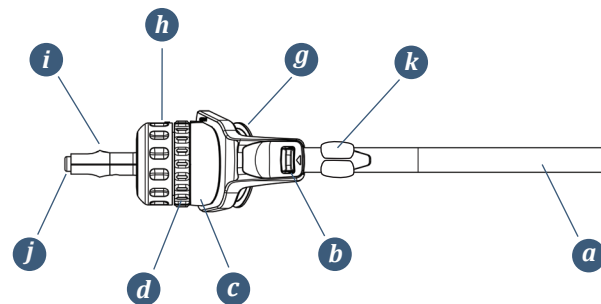

Setting up Vesticam2 IR video Goggles on your patient.

1 Start with the camera cylinder and eye patch cylinder off...not attached to the goggles. **Open viewing software first, then connect the Vesticam camera to the viewing device.**

2 Follow your normal patient hygiene pathways. Use effective alcohol/anti-microbial wipes to **clean goggles face plate **f**, silicone eye cups **a** and head band **g** before and after each patient.** Do not use on patients with infective disorders. (see full instruction manual [🔗](#))

3 **Loosen the head strap** by squeezing the **quick release buttons** and the goggles flange **b** together.

4 Help your patient to **position the goggles for comfort.** Most patients can do this themselves, like swimming goggles.

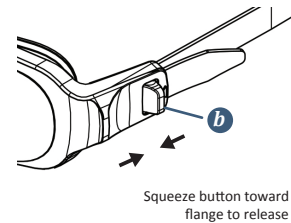

5 **To adjust for interpupillary distance,** loosen the locking rings **d** at the front of the mounting plate by turning anti-clockwise. Allow the mounting plates to slide into a comfortable position on your patient's face. Your patient should be able to see out of both viewing holes.

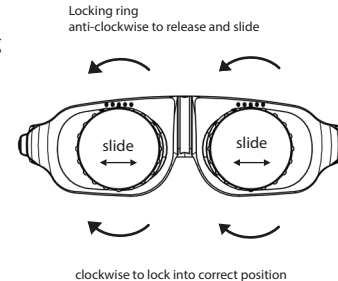

6 Pull rubber tags at each side of goggles gently **to tighten the headband**, then lock the mounting plates into place by turning the locking rings clockwise.

7 Hold the camera cylinder **h** so that the lead is exiting the cylinder at "5 o'clock". **Insert the camera cylinder into the mounting plate and rotate it clockwise until it "clicks" and locks into place** (lead should be at "6 o'clock" when locked).

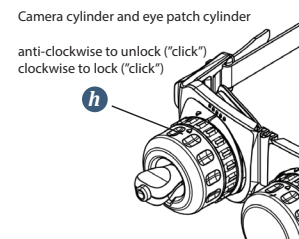

8 Hold the camera cylinder stable and move the camera joystick up/down and side/side until the eye image is central on screen.

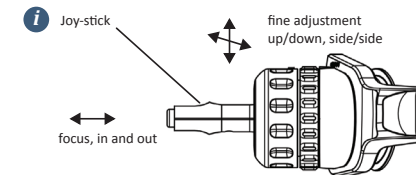

9 **To focus** the image of the iris and edge of the pupil, firmly **pull the camera joystick **i** in/out.** The camera cannot be pushed into the eye as there is an end stop. It is important to focus the eye to ensure that possible torsion is visible.

10 For binocular units, repeat steps 7-9 with the second camera.

FIXATION LIGHT:

Press the small button **j** at the end of the joystick to activate the fixation light. When the button is **IN**, the fixation light is **ON**. When the button is **OUT**, the fixation light is **OFF**.

NOTE: the fixation light will only work when the camera is plugged into the external recording device (phone, tablet or computer).

Vesticam2 goggles are designed to be light tight. Adjust the goggles with your patient so they are comfortable, secure.

In the case of light leakage, check that the camera cylinder, eye patch cylinder and eye cups are correctly in place. If there is any light leakage, gently move the goggles on your patient's face to eliminate any gaps between face and goggles.

Intended use:



Vesticam2 IR video goggles are intended to support realtime observations of eye movements, with and without fixation. The viewing and recording of eye movement requires connection to a separate device and software.

Vesticam2 IR video goggles are intended to be used by trained health professionals. The user remains entirely responsible for their choice of specific bedside tests. The target population is 12+ years of age.

Use of Vesticam2 IR video goggles is contraindicated in patients with recent facial trauma, broken skin, and recent eye surgery.

General care:

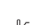
Never use damaged or broken Vesticam2 IR goggles. If you are unsure, or for Vesticam2 repairs, please contact support@vesticam.com

-  Avoid heating over 50°C (122°F) when transporting. Recommended use: temperature 16° C - 29° C (60°F - 85°F); humidity 30-80%.
-  Keep the camera dry at all times.

-  Avoid dropping your Vesticam unit or recording device.

Take care when connecting and disconnecting the camera or any adaptors to your recording device. The USB ports can be damaged if not used correctly.

Follow your normal service and maintenance pathways for maintenance of the charging attachments and USB 240v wall socket charger supplied with your recording device.

Lock your Vesticam unit with your other medical equipment/medical records after use.

Compliance and PHI Management:

Vesticam is intended for eye movement viewing only.

- All recordings of eye movements (considered PHI) are the property of the user or purchasing organization. Vesticam does not collect, access, or host any data.
- Use is not cloud-based and does not require a WiFi connection.
- Users are responsible for adhering to their organisation's Electronic Medical Record (EMR) pathways for the secure handling, storage, and transfer of patient data.

Vesticam2 cleaning and avoiding contamination

Follow your normal patient infection control pathways when applying Vesticam goggles. Use of PPE and general environmental cleaning is the responsibility of the user.

Use of Vesticam IR video goggles may be contraindicated in patients who are infectious or have broken skin.

Remove the camera cylinder prior to cleaning.

Use effective anti-microbial and antibacterial wipes (or alcohol wipes) to wipe over and clean the silicone eye cups, goggles mounting plate, head band and any exposed surfaces before and after each patient. Allow the goggles to sit for 60 seconds, and to air dry before use.

Do not autoclave. Do not use hard or pointed objects to clean any part of the Vesticam unit.

Do not allow liquid to enter any part of the goggles camera unit. The **Vesticam camera lens** (visible when looking into the camera cylinder) should be checked regularly for stains and dust, and should be cleaned as required using a standard spectacle lens cloth.

The silicone eye cups can be removed, washed and air dried separately and then placed back onto the mounting plate if required. Extra eye cups are available for purchase.

The goggles mounting plate, head band and eye cups can be immersed in gentle cleaning detergent, rinsed and allowed to air dry completely if required.

Vesticam™: Vesticam Pty Ltd

29 Endeavour Drive

Bellingen, 2454, NSW, Australia

p:1300141488

e:support@vesticam.com w:www.vesticam.com

Vesticam2 IR video goggles

Monocular ☐ Binocular ☐ Android Device ☐

 Serial # _____

Checked: _____ / _____ / _____



An accessible, reliable, and portable video frenzel solution



Quick Start manual
Vesticam2 IR video goggles
(monocular and binocular)